

9<sup>th</sup> Biennial Association of  
Natural Resource Extension Professionals Conference  
May 18-22, 2014 Sacramento, California

# Golden Opportunities

---

The Role of Education and Community  
Engagement in Sustaining Natural Resources



University of California  
Division of Agriculture and  
Natural Resources

**9<sup>th</sup> Biennial Association of  
Natural Resource Extension Professionals Conference**  
May 18-22, 2014  
Hyatt Regency, Sacramento, California

---

**Golden Opportunities**

The Role of Education and Community Engagement in  
Sustaining Natural Resources

---

**Conference Sponsors**

Association of Natural Resource Extension Professionals  
University of California Division of Agriculture and Natural Resources  
USDA Forest Station, Pacific Southwest Research Station

**Travel Scholarship Awardees**

Kristina Cervantes-Yoshida, University of California  
Moana Ching, University of Hawaii  
Hyeyeong Choe, University of California  
Danielle Dolan, University of California  
Kelly Easterday, University of California

Tiffany Fegel, West Virginia University  
Valerie Grant, West Virginia University  
Mark Reynolds, University of California  
Hillary Sardiñas, University of California  
Jessica Sutt, University of Florida

<http://ucanr.edu/sites/ANREP/>

## Table of Contents

Conference Sponsors .....	1
Travel Scholarship Awardees .....	1
Conference Committee.....	3
Welcome to Sacramento! .....	4
Conference Purpose.....	5
About ANREP.....	5
Program of Events.....	6
ANREP Silent Auction .....	6
Study Tours .....	10
Robert Mondavi Institute for Wine and Food Science at UC Davis .....	10
Stone Lakes National Wildlife Refuge.....	10
Study Tours .....	11
UC Berkeley Blodgett Forest Research Station.....	11
Sacramento-San Joaquin River Delta .....	11
Concurrent Sessions.....	12
Monday, May 19 .....	12
Tuesday, May 20 .....	13

## Conference Committee

### **ANREP Executive Committee**

---

**Robert “Bob” Bardon**, 2014 President, North Carolina State University

**Sanford “Sandy” Smith**, 2013 President, Penn State University

**Dean Solomon**, President-Elect, Michigan State University

**Bill Hubbard**, Executive Secretary, University of Georgia

**Greg Frey**, Treasurer, Virginia State University

**Dana Rizzo**, Secretary, Penn State University

**Amy Rowe**, North East Region Representative, Rutgers University

**Peter Warren**, Western Region Representative, University of Arizona

**Lara Miller**, Southern Region Representative, University of Florida

**Kris Tiles**, North Central Region Representative, University of Wisconsin

### **Planning Committee Co-Chairs**

---

**Bill Frost**, University of California, Division of Agriculture and Natural Resources

**Rick Standiford**, University of California, Division of Agriculture and Natural Resources

### **Planning Committee Members**

---

**James Henderson**, Mississippi State University

**Susie Kocher**, University of California, Division of Agriculture and Natural Resources

**Stephanie Larson**, University of California, Division of Agriculture and Natural Resources

**Michelle Leinfelder-Miles**, University of California, Division of Agriculture and Natural Resources

**Scott Oneto**, University of California, Division of Agriculture and Natural Resources

**Bill Stewart**, University of California, Division of Agriculture and Natural Resources

### **Logistics**

---

**Sherry Cooper**, University of California, Division of Agriculture and Natural Resources,  
Program Support Unit

**Alex Zabelin**, University of California, Division of Agriculture and Natural Resources,  
Program Support Unit

## Welcome to Sacramento!

---

### *9<sup>th</sup> Biennial ANREP Conference*

Welcome to the 9<sup>th</sup> Biennial Conference of the Association of Natural Resource Extension Professionals. We are pleased to be here in the heart of the state with opportunities for you to explore the incredible diversity of California. You are sitting across the street from our state capitol and close to historic Old Sacramento which was the hub of California activity during the Gold Rush, and in the middle of the Sacramento Valley with its vast array of agricultural production. Within minutes to the east you can be in the foothills of the Sierra Nevada and its extensive oak woodlands and annual grasslands, just a bit further up the hill are the majestic conifer forests and just over the hill to the unique treasure of Lake Tahoe. Traveling minutes to the west you can be in the midst of the Delta Region with its diversity of agriculture, wildlife and fisheries habitat, and a myriad of water issues with statewide ramifications. Just beyond is the San Francisco Bay Area with its surprising rich array of open space utilized for recreation and agricultural production in and amongst the cities. Cooperative Extension professionals are actively playing a role in all of these areas, addressing critical issues in water management, science literacy, management of range and forest lands, air quality, among the litany of issues of which you are all well aware.

You will experience Gold Rush-era attractions, outdoor adventures, and dining and cultural arts for every taste as you share your experience with others interested in developing innovative and effective natural resource extension and engagement programs and partnerships at the conference. Topics connecting many natural resource and community engagement disciplines include wildlife, forestry, water quality, fisheries, sustainability, youth education, community engagement, and more.

We are excited to have you here in California. We are looking forward to a productive and rewarding conference filled with informative sessions and to reconnecting with friends and colleagues and making new connections.

#### **William E. Frost**

Associate Vice President, University of California, Division of Agriculture and Natural Resources

Co-chair, Planning Committee

#### **Richard B. Standiford**

Cooperative Extension Forester, University of California, Berkeley

Co-chair, Planning Committee

## Conference Purpose

The 9<sup>th</sup> Biennial ANREP National Conference hosted by the University of California offers a forum to share innovative extension educational programs directed to sustaining natural resources. The purpose of this conference is to help Extension professionals and those who work with them share their programming successes and challenges and learn from others to facilitate communication, cooperation and networking among natural resource Extension educators. This interaction will strengthen Extension program needs assessment, development, delivery, and impact evaluations skills, thus enabling participants to better address traditional and emerging issues important to a diverse clientele. Sharing of information and experiences will foster multi-state, multi-institutional, and global collaborations. Other important outcomes include building a cohesive, structured, multi-disciplinary support base for Extension natural resource programs in the future, and enhancing the visibility, credibility, and relevance of natural resource programs in the context of Extension's overall mission.

## About ANREP

ANREP is a national association for Cooperative Extension Service (CES) professionals working in environmental education, fisheries, forestry, wood sciences, range, recreation, waste management, water, wildlife, and related disciplines. Members are active and retired CES employees at the county, area, state, or national level.

### ***What are ANREP's objectives?***

- Bring Extension professionals together to discuss mutual natural resource issues, needs, and opportunities
- Advance natural resource Extension through continuing education for Extension professionals
- Promote cooperation among states and regions, agencies, associations, and businesses on natural resource education programs
- Develop, sponsor, and promote education and training that advance natural resource management
- Strengthen communication with Extension administrators

### ***How is ANREP structured?***

ANREP is managed by a President, President-elect, Secretary, Treasurer, and four Regional Representatives. Committees deal with strategic planning, communications, policies, awards, and membership. General membership meetings are held annually. ANREP is a member of the Joint Council of Extension Professionals (JCEP), which promotes communication, cooperation and professionalism among Extension professional organizations, ECOP, and USDA-CSREES.

---

*For more information about ANREP and how to join, visit the ANREP website at [www.anrep.org](http://www.anrep.org).*

## Program of Events

Sunday  
May 18

- 10:00-Noon **ANREP Executive Committee Meeting**  
LOCATION: Suite 702  
HOST: Bob Bardon, ANREP President, rebardon@ncsu.edu
- 12:30-3:30 **Climate Science Initiative/NNSLE Pre-Conference Meeting**  
LOCATION: Tahoe  
HOST: Chris Jones, ckjones@cals.arizona.edu
- 2:30-5:00 **5K Fun Run/Walk**  
Check in at 2:30 PM and pick up number and route map; Run/Walk will begin at 3 PM  
LOCATION: Meet in the lobby of the Hyatt
- 4:00-6:00 **Speaker Ready Room**  
Staff will be on hand to collect presentations and posters  
LOCATION: Trinity
- 4:00-6:00 **Conference Registration**  
LOCATION: Regency Ballroom Foyer  
*Pick up your conference packet*
- 5:00-7:00 **Welcome Reception**—light hors d'oeuvres and no-host bar  
LOCATION: Regency F  
*Please wear your name badge and have tickets for guests in hand.*

### ANREP Silent Auction

LOCATION: Ventura on the Mezzanine

WHEN: Monday and Tuesday during AM breakfast, breaks and lunch

CONTACT: Steve McConnell, SMCCONNELL@spokanecounty.org

**Be sure to visit the ANREP Silent Auction and place your bids!**

We'll close the bidding on Tuesday night and let you know who has the winning bids on Wednesday.

**Items for bidding include:**

- Yerba mate kits from Paraguay (mate, "guampa," and "bombilla.")
  - Handknit socks
  - Wildlife Art Print
  - Necklaces – three of them!
  - ANREP CSI Team Sweatshirts (1 L, 1 XL)
  - Items from New York State – books, maple syrup and more!
  - Baseball caps (Washington State Forest Stewardship)
  - A Minnesota themed basket!
- And more...!!

7:00-8:00 am **Conference Registration** LOCATION: Regency Foyer  
**Continental Breakfast** LOCATION: Regency A/B  
 7:00-1:30 pm **Speaker Ready Room** LOCATION: Trinity (staffed during these hours)  
**Silent Auction** during breakfasts/breaks/lunch in Ventura

8:00-10:15 LOCATION: Regency C

---

8:00 **Opening Remarks** by the Planning Co-Chairs  
 Bill Frost, Associate Vice President, UC Division of Agriculture and Natural Resources  
 Rick Standiford, Cooperative Extension Forest Management Specialist, UC Berkeley

8:15 **Native American Resource Management**  
 M. Kat Anderson, National Ethnoecologist, USDA Natural Resources Conservation Service

8:45 **Water**  
 Doug Parker, Director, California Institute for Water Resources, UC Division of Agriculture and Natural Resources

9:05 **Fire**  
 Brandon Collins, Research Forester, UC Berkeley

9:25 **Fisheries**  
 Peter Moyle, Professor in the Dept. of Wildlife, Fish, & Conservation Biology, UC Davis

9:45 **Natural Resource Programming in UC: Staffing, Issues, Priorities**  
 Barbara Allen-Diaz, Vice President, UC Division of Agriculture and Natural Resources

10:00 **ANREP Welcome**  
 Bob Bardon, ANREP President and North Carolina State University

10:15 *BREAK in the Regency Foyer*

10:45 **Concurrent Session A**  
 A1 Education Methods LOCATION: Regency C  
 A2 Water Quality LOCATION: Regency D  
 A3 Reaching Clientele LOCATION: Regency E  
 A4 Energy LOCATION: Regency F

12:30 pm **Lunch**  
 Speaker: Karen Ross, Secretary, California Dept. of Food and Agriculture  
 LOCATION: Regency A/B

1:30 **Concurrent Session B**  
 B1 Forestry and Fisheries LOCATION: Regency C  
 B2 Water Quality LOCATION: Regency D  
 B3 Reaching Clientele LOCATION: Regency E  
 B4 Community Development LOCATION: Regency F



**Monday  
May 19**

3:00 BREAK *in the Regency Foyer*

Set up for Poster Reception LOCATION: Regency A/B

3:30 **Concurrent Session C**

C1 Workshop: Wildlife, Community Dev., Land Use Planning

LOCATION: Regency C

C2 Workshop: Maximizing the Benefits of Integrated Extension

LOCATION: Regency D

C3 Roundtable: Catalyzing Community Engagement to Sustain Lasting Impact in River Restoration

LOCATION: Regency E

C4 Community Development and Climate Change

LOCATION: Regency F

5:30 **ANREP Leadership Meeting**

LOCATION: Regency C

6:00 Poster and Strolling Dinner Reception with no-host bar

LOCATION: Regency A/B

**Tuesday  
May 20**

7:00-8:00 am **Conference Registration** LOCATION: Regency Foyer

**Continental Breakfast** LOCATION: Regency DEF

7:00-Noon **Speaker Ready Room** LOCATION: Trinity

**Silent Auction** during breakfasts/breaks/lunch in Ventura

8:00 **Concurrent Session D**

D1 Workshop: Natural Resource Education

LOCATION: Regency A

D2 Workshop: Tools and Approaches to Effective Water Quality Monitoring of BMPs for Stream Systems

LOCATION: Regency B

D3 Workshop: Civic Engagement in Management of Natural Resources

LOCATION: Regency C

D4 Forestry

LOCATION: Golden State

10:00 BREAK *in the Regency Foyer*

10:30 **Concurrent Session E**

E1 Bioenergy and Technology Tools

LOCATION: Regency A

E3 Environmental Education

LOCATION: Regency C

E4 Forestry

LOCATION: Golden State

10:30-11:30 E2 Roundtable: Creating a National Stormwater Core Curriculum

LOCATION: Regency B

11:30-Noon E2 Water Quality

LOCATION: Regency B

Noon-1:00 Buffet Lunch LOCATION: Regency DEF

**Visit the Ventura Room to bid on silent auction items before bidding closes on Tues., at 5 p.m.!**

Tell us what you think by completing the online evaluation at  
[ucanr.edu/anrepevaluation](http://ucanr.edu/anrepevaluation)



1:00	<b>Concurrent Session F</b> F1 Technology Tools F2 Water Quality F3 Environmental Education F4 Forestry	LOCATION: Regency A LOCATION: Regency B LOCATION: Regency C LOCATION: Golden State
3:00	BREAK <i>in the Regency Foyer</i>	
3:30	<b>Concurrent Session G</b> G1 Technology Tools & Leadership G2 Water Quality G3 Environmental Education G4 Range	LOCATION: Regency A LOCATION: Regency B LOCATION: Regency C LOCATION: Golden State
5:00-7:00	<b>ANREP Action Planning Meeting</b> LOCATION: Capitol View (15 <sup>th</sup> floor) HOST: Mindy Habecker, Habecker@countyofdane.com	
5:00-7:30	<b>Society for Range Management</b> LOCATION: Capitol Board Room HOST: Sheila Barry, sbarry@ucanr.edu	

7:00-8:00 am	<b>Continental Breakfast</b>	LOCATION: Regency Corridor
8-NOON	LOCATION: Regency DEF	

8:00	<b>Opening Remarks and Introductions</b> Barbara Allen-Diaz, Vice President, UC Division of Agriculture and Natural Resources	
8:20	<b>Overview of Climate Change Issues: Ecology, Physiology, Trends</b> Dennis Baldocchi, Professor in the Department of ESPM, UC Berkeley	
8:40	<b>CalAdapt: An Example of a Planning and Education Tool for California Climate Change Policy</b> Kevin Koy, Executive Director, Geospatial Innovation Facility (GIF), College of Natural Resources, UC Berkeley	
9:00	<b>Overview of the ANREP Climate Science Initiative</b> Chris Jones, Associate Agent, Gila County Cooperative Extension, University of Arizona	
9:20	<b>Discussion:</b> Panelists' responses and audience comments	
9:45	Break <i>in the Regency Corridor</i>	
10:15	<b>ANREP Business Meeting and Awards</b>	
Noon	Adjourn to lunch on your own unless joining a tour	
1:00-5:00	<b>WERA-1020 Western Water Resources Coordinating Committee</b> LOCATION: Big Sur HOST: Doug Parker, doug.parker@ucop.edu	

## Study Tours

### Robert Mondavi Institute for Wine and Food Science at UC Davis

Date and Time: Wednesday, May 21, 12:30-5:00 pm

Tour registration: Noon-12:30 in the foyer of the Hyatt Regency  
Bus will depart at 12:30 pm  
Lunch provided

Tour Leader: Susie Kocher, Forestry/Natural Resources Advisor, in UC Division Agriculture and Natural Resources, El Dorado County

Tour of the edible garden, LEED Platinum Experimental Winery, olive oil sensory lab and native plant gardens at the UC Arboretum. This UC Davis facility is the first brewery, winery or food processing facility in the world to be LEED Platinum certified. The building provides research and operational facilities for on-site energy production, rainwater harvesting, water reuse and carbon sequestration systems for the LEED Platinum winery. The winery is self-sustainable in energy and water, and fully solar at peak load with a zero carbon footprint. We will also enjoy an olive oil tasting and stop by the RMI edible garden before continuing our tour.

...at the UC Arboretum. Here we will visit the California Foothill Collection with displays of large trees and shrubs native to the foothills surrounding the Central Valley, including several majestic 200-year-old Valley oaks, pines, ceanothus, and several species of native currants and gooseberries. We will also visit the Mary Watis Brown Garden of California Native Plants includes an extensive collection of native plants that work well in home landscapes, arrayed along meandering paths under stately oaks.

<http://rmi.ucdavis.edu/>

---

### Stone Lakes National Wildlife Refuge

Date and Time: Wednesday, May 21, 12:30 – 5:00 pm

Tour registration: Noon-12:30 in the foyer of the Hyatt Regency  
Vans will depart at 12:30 pm  
Lunch provided

Tour Leaders: Bill Frost, Associate Vice President, UC Division Agriculture and Natural Resources  
Rick Standiford, CE Specialist in the Center for Forestry, UC Berkeley

An urban refuge located 10 miles from downtown Sacramento, Stone Lakes NWR is conserving and enhancing Central Valley habitat and wildlife. Presentations will be provided on:

History and Overview of Stone Lakes	Environmental Education / Youth Program
Native grass and tree restoration projects	Burrowing Owl restoration project
Grazing Program	Ag Program
And other topics of interest	

[http://www.fws.gov/refuge/stone\\_lakes/](http://www.fws.gov/refuge/stone_lakes/)

## Study Tours

### UC Berkeley Blodgett Forest Research Station

Date and Time: Thursday, May 22, 8:30 am-5:00 pm

Tour registration: 7:30-8:30 am in the foyer of the Hyatt Regency  
Vans will depart at 8:30 am  
Lunch provided

Tour Leaders: Bill Stewart, CE Specialist at the Center for Forestry, UC Berkeley

Blodgett Forest, situated on the Georgetown Divide, consists of high site mixed conifer forest, oak forest, and brushland gradients on a gently rolling topography with an average slope of less than 30 percent. Elevation on the main tract ranges from 3,900' to 4,800' (1,200 m to 1,500 m). Three major creeks flow through the Forest. Over 400 species of plants on the property provide habitat for 150 species of animals. Four major soil types are found on Blodgett. The scientific value of Blodgett has grown with the corresponding increase of the demands on natural resources. Blodgett Forest has a detailed fifty-year history which includes studies of tree growth, forest succession, harvesting costs, forest insect and disease dynamics, forest ecology, wildlife population dynamics, range animal dynamics, control of non-tree vegetation, thinning and spacing of commercial conifers, soil compaction from logging operations, effects and techniques of prescribed fire, conifer regeneration methods, harvesting methods, nutrient cycling, and much more. We'll visit a shaded fuel break, a typical industrial forest with recent harvest and regeneration, single tree selection sites, bioenergy-producing thins and more.

[http://ucanr.edu/sites/cff/Blodgett\\_Forest\\_Research\\_Station/](http://ucanr.edu/sites/cff/Blodgett_Forest_Research_Station/)

---

### Sacramento-San Joaquin River Delta

Date and Time: Thursday, May 22, 8:30 am-5:00 pm

Tour registration: 7:30-8:30 in the foyer of the Hyatt Regency  
Vans will depart at 8:30 am  
Lunch provided

Tour Leader: Michelle Leinfelder, CE Advisor in UC Agriculture and Natural Resources, San Joaquin County

The Sacramento-San Joaquin River Delta is the largest estuary west of the Mississippi River, and it is a thriving agricultural region. Fertile soils, over a thousand miles of waterways, and abundant wildlife characterize the region. The Delta is also the center of California's water delivery system. We'll learn more about the Delta by visiting R. Kelley Farms and the Advanced Hardwood Biofuels Poplar Demonstration site, hearing a presentation during lunch on the Economics of Water, and touring Staten Island M. & T. Ranch and the Consumnes River Preserve.

# Concurrent Sessions

Monday, May 19

	<b>A1 Education Methods</b> Moderator: Marina Denny Regency C	<b>A2 Water Quality</b> Moderator: Amy Rowe Regency D	<b>A3 Reaching Clientele</b> Moderator: Holly George Regency E	<b>A4 Energy</b> Moderator: Diomy Zamora Regency F
10:45-11:15	#52 Florida Seafood At Your Fingertips: An Outreach Program for the Florida Consumer, <i>Saari, Brooke</i>	#24 Ohio River Basin Wetland Conservation Planning Project, <i>Iles, Jerome</i>	#59 Invasive Blitz: Training Master Volunteers to Remove and Manage Invasive Species, <i>Strauss, Andrea Lorek</i>	#25 Maryland Wood Energy Coalition: A Model for Policy Change & Coalition Building, <i>Kays, Jonathan</i>
11:15-11:45	#49 Rutgers Environmental Steward Program, <i>Rector, Patricia</i>	#10 A Watershed Group's Approach to Public Outreach for Floodplain Protection, <i>Cobourn, John</i>	#34 Expanding Extension's Clientele through Collaborative Partnerships, <i>Madhosingh-Hector, Ramona</i>	#37 The Dragon Wagon and the Utah Biomass Resources Group, <i>McAvoy, Darren</i>
11:45-12:15	#57 An Experimental Approach to Science Delivery: Using Extension to Develop a Knowledge to Action Network, <i>Stevenson, John</i>	#32 Research and Education Envoys with the Regulatory and Regulated Communities, <i>Lewis, David</i>	#60 Master Composter Programs to Meet the Changing Clientele of Extension, <i>Tedrow, Amanda</i>	#12 Transitioning from the Bucket to the Barrel Educational Biofuels Webinar Series, <i>Cser, Helene</i>
	<b>B1 Forestry and Fisheries</b> Moderator: Brooke Saari Regency C	<b>B2 Water Quality</b> Moderator: Diana Rashash Regency D	<b>B3 Reaching Clientele</b> Moderator: Susan Moore Regency E	<b>B4 Community Development</b> Moderator: Holly George Regency F
1:30-2:00	<b>Forestry</b> - #51 Natural Resource Education and Community Engagement in an Adaptive Management Project, <i>Rodrigues, Kim</i>	#7 Minnesota's Watershed Education Program, <i>Burkett, Eleanor</i>	#16 Hydrilla IPM RAMP-Starting a Statewide Extension Project, <i>Gioeli, Kenneth</i>	#53 Enhancing the Value of Indiana's Public Spaces, <i>Salazar, Kara</i>
2:00-2:30	<b>Fisheries, Public Policy</b> - #21 Engaging Stakeholders in Fisheries Management, <i>Hazell, Joy</i>	#47 Florida-Friendly Best Management Practices for the Protection of Water Resources by the Green Industry, <i>Rainey, Donald</i>	#31 Mapping the Dynamics of Social Resilience in a Forest Management Setting: Use of Affiliation Network Analysis of Public Meetings and Participants in the Sierra Nevada Adaptive Management Project, <i>Lei, Shufei</i>	#55 Blending Technology and Face-To-Face Approaches to Meet Land Use Training Needs in Northern Michigan, <i>Solomon, Dean</i>
2:30-3:00	<b>Forestry</b> - #14 How Extension Can Spark Collaboration, <i>Evans, Jennifer</i>	#42 Measuring the Public Value of a Stormwater Education Program, <i>Missaghi, Shahram</i>	#43 Teaching Teachers about Climate Change: Factors for a Successful Symposium, <i>Monroe, Martha</i>	#5 Charting the Course for the Bluewater Coast: Working towards Sustainable Coastal Community Development, <i>Bohling, Mary</i>

Monday cont'd.				
	<b>C1 Workshop</b> Moderator: Dean Solomon Regency C	<b>C2 Workshop</b> Moderator: John Cobourn Regency D	<b>C3 Roundtable</b> Moderator: Jennifer Gagnon Regency E	<b>C4 Community Development/Climate Change</b> Moderator: Andrea Lorek Strauss Regency F
3:30-4:00	<b>Wildlife, Community Development, Land Use Planning - #W2</b> Building Local Capacity for Conservation and Land Use Planning in Hudson Valley Communities: Tools, <i>Heady, Laura</i>	#W5 Maximizing the Benefits of Integrated Extension, Teaching, and Research Teamwork for Stormwater Management, <i>Rodie, Steven</i>	#R2 Catalyzing Community Engagement to Sustain Lasting Impact in River Restoration: Wisconsin Extension, <i>Epping Overholt, Gail</i>	<b>Community Development - #1</b> RU goes Organic: Developing an Organic Land Care Extension Program for Professional Landscapers, <i>Bakacs, Michele</i>
4:00-4:30				<b>Climate Change - #8</b> Conducting Climate Change Outreach in a County Extension Setting, <i>Carnahan, Libby</i>
4:30-5:00			<b>Climate Change - #19</b> Creating Climate Change Ready Communities in Wisconsin, <i>Habecker, Mindy</i>	
5:00-5:30			<b>Climate Change - #58</b> Engaging Landowners on Forests and Climate: Outcomes of a 2013 NRC Workshop, <i>Norland, Eric and Sagor, Eli</i>	

## Tuesday, May 20

	<b>D1 Workshop</b> Moderator: Barbara Bennett Regency A	<b>D2 Workshop</b> Moderator: John Cobourn Regency B	<b>D3 Workshop</b> Moderator: Donald Hanley Regency C	<b>D4 Forestry</b> Moderator: Diomy Zamora Golden State
8:00-8:30	<b>Natural Resource Education - #W3</b> New Directions for Statewide Naturalist Education Programs: Citizen Science and Diversity, <i>Merenlender, Adina</i>	#W4 Tools and Approaches for Effective Water Quality Monitoring of BMPs for Stream Systems, <i>Paige, Ginger</i>	#W1 Civic Engagement in Management of Natural Resources - The Role of Cooperative Extension, <i>George, Holly</i>	#26 Engaging audiences through Video: Communicating with Forest Landowners Effectively and Interestingly, <i>Krantz, Shelby</i>
8:30-9:00				#15 On-line Woodland Options for Landowners Course: Impacts and Evaluation, <i>Gagnon, Jennifer</i>
9:00-9:30				#17 Forest and Woodland Certification Outreach for Mississippi Farms, <i>Gordon, Jason</i>
9:30-10:00				#46 Uneven-aged Management in a Mixed-conifer Forest: A Case Study with Innovative Education, <i>Parker, Bob</i>

Tuesday cont'd.				
	<b>E1 Bioenergy and Technology Tools</b> Moderator: Stephanie Larson Regency A	<b>E2 Roundtable and Water Quality</b> Moderator: Amy Rowe Regency B	<b>E3 Environmental Education</b> Moderator: Mary Tebo Davis Regency C	<b>E4 Forestry</b> Moderator: Mike Schira Golden State
10:30-11:00	<b>Roundtable - #R4</b> Strengthening Extension Capacity for Bioenergy Program Outreach, <i>Kar, Shiba</i>	<b>Roundtable - #R5</b> Creating a National Stormwater Core Curriculum, <i>Missaghi, Shane</i>	#39 Traveling Tree Walk: An Ecosystem Services Outreach Project, <i>Miller, Lara</i>	#69 Engaging Communities through Volunteer Monitoring in Montana, <i>Sigler, Adam</i>
11:00-11:30			#9 Mining and Environmental Educational Modules for Tribal Colleges, <i>Chief, Karletta</i>	#18 Process vs. Product: Evaluating the Importance of Landowner Engagement in Forest Management Planning, <i>Grotta, Amy</i>
11:30-12:00	<b>Technology Tools - #27</b> Evaluating Websites and Web Tools in Extension Education, <i>Monroe, Martha</i>	<b>Water Quality - #50</b> River Friendly Business Program, <i>Rector, Pat</i>	#2 Interpreting Ecosystem Services and Working Rangelands for an Urban Audience, <i>Barry, Sheila</i>	#45 How to Manage Your Forest: Using New Technologies to Enhance and Expand Outreach Education, <i>Parker, Bob</i>
	<b>F1 Technology Tools</b> Moderator: Jim Sullins Regency A	<b>F2 Water Quality</b> Moderator: Dean Solomon Regency B	<b>F3 Environmental Education</b> Moderator: Diana Rashash Regency C	<b>F4 Forestry</b> Moderator: Mike Schira Golden State
1:00-1:30	#65 Cost-Benefit Decision Tool to Help Transportation Agencies and Landowners Establish Living Snow Fences, <i>Wyatt, Gary</i>	#30 Pathogen Risks from Livestock, Wildlife and the Environment in the California Central Coast, <i>Larsen, Royce</i>	#41 Enriching Florida's Teachers Through Environmental Education Training, <i>Miller, Lara</i>	#28 Updating Extension Programs to Improve Marketing, <i>Kushla, John</i>
1:30-2:00	#11 Technology for Today's Extension: The Wisconsin Idea at Work, <i>Cook, Chad</i>	#3 Using Multiple Approaches for Program Evaluation: Case Studies from Minnesota's NEMO Program, <i>Bilotta, John</i>	#38 Get Outdoors with Extension!, <i>McGee, Shannon</i>	#23 Assessment of the Adoption Practices of Agroforestry Technologies by Limited-Resource Farmers in NC, <i>Idassi, Joshua</i>
2:00-2:30	#36 Extension for Sustainability: Web-based Participatory Extension Resource for Natural Resources, <i>Mashiri, Fadzayi</i>	#63 StreamWise Students Tackle Water Quality Challenges, <i>Werling, Rachel</i>	#67 Youth and Water Program, <i>Rector1394, Pat</i>	#66 Educating Farmers and Natural Resource Professionals on Agroforestry, <i>Zamora, Diomy</i>
2:30-3:00	#68 Invasive Species Education Through a Social Media Team Approach, <i>Saari, Brook</i>	#13 IDAH2O: Master Water Stewards Serving Idaho Through Volunteer Monitoring, <i>Ekins, Jim</i>	#56 SLO Scientists: Engaging Youth and Adults in Non-Formal Natural Resource Education, <i>Soule, Katherine</i>	#61 Youth Summer Forestry Leadership Program: Workforce Preparation and Life Skill Development, <i>Teuteberg, Dan</i>

<b>Tuesday cont'd.</b>				
	<b>G1 Technology Tools and Leadership</b> Moderator: Jim Sullins Regency A	<b>G2 Water Quality</b> Moderator: Jessica Sutt Regency B	<b>G3 Environmental Education</b> Moderator: David Shelton Regency C	<b>G4 Range</b> Moderator: Stephanie Larson Golden State
3:30-4:00	<b>Technology Tools - #44</b> Expanding Reach: A Climate Change Adaptation Virtual Symposium, <i>Moore, Susan</i>	<b>#40 Watershed Education</b> for Elected Officials, Resource Managers, and Concerned Citizens, <i>Miller, Lara</i>	<b>#54 The Greenhouse Project:</b> Engaging the Community to Educate Youth, <i>Skelly, JoAnne</i>	<b>#62 The Rancing Sustainability Analysis System,</b> <i>Tietje, Bill</i>
4:00-4:30	<b>Leadership - #6 ANREP's</b> New Professional Development Committee: Lessons Learned in Webinar Development, <i>Burkett, Eleanor</i>	<b>#4 The Watershed Game:</b> Interactive Simulation for Watershed-wide Education and Implementation, <i>Bilotta, John</i>	<b>#22 Connecting Middle School Students</b> with the Hogtown Creek Watershed in Gainesville, FL, <i>Hermansen-Baez, Annie</i>	<b>#29 Thirteen Years of Forage Monitoring</b> on the California Central Coast Shows Tremendous Variation in Rainfall, Production and Plant Species Composition, <i>Larsen, Royce</i>
4:30-5:00	<b>Leadership - #48 Walking Our Talk:</b> Exploring Practices, Motivations, and Impediments among Extension Personnel, <i>Rashash, Diana</i>	<b>#20 Bringing Water Quality Education to the World</b> via eXtension, <i>Haddock, Susan</i>	<b>#35 Engaging Youth in Energy Conservation,</b> <i>Madhosingh-Hector, Ramona</i>	<b>#33 Made in the Shade:</b> Riparian Restoration Effectiveness on California's Livestock Grazing Landscapes, <i>Lewis, David</i>

**Visit the Ventura to bid on silent auction items before bidding closes on Tues., at 5 p.m.!**

Tell us what you think by completing the online evaluation at [ucanr.edu/anrepevaluation](http://ucanr.edu/anrepevaluation)





**HYATT REGENCY SACRAMENTO**  
 1209 L Street  
 Sacramento, CA 95814, USA

T: +1 (916) 443 1234  
 F: +1 (916) 321 3639  
 sacramento.hyatt.com



**FLOOR PLAN**  
*Second Floor*

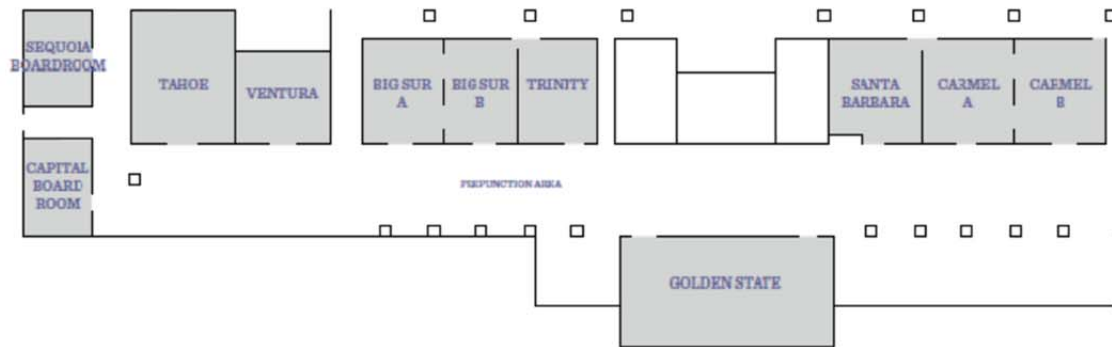

**FLOOR PLAN**  
*First Floor*

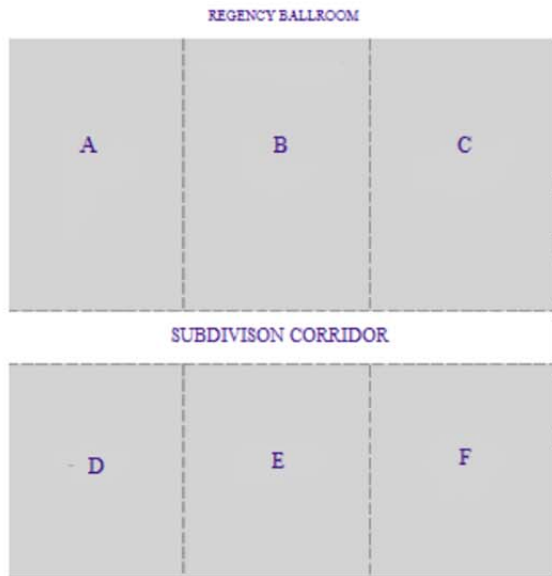

**FLOOR PLAN**  
*15th Floor*

