

FOREST STEWARDSHIP COMMUNITY NEWS

Winter 2024

X Marks the Spot...

Prior to joining the Forest Stewardship team, I hadn't given much thought to maps. Tech innovation has made it so the extent of my interaction with maps is plugging an address into my phone and following instructions dictated by a (sometimes annoyingly calm) robot voice.

Yet after spending time at field days and CA Tree School sessions speaking to forest landowners who learned to skillfully map their properties, I've begun to understand how exciting maps can be. Similar to silviculture, cartography is defined as both an art and a science- and mapping can help landowners share the features and personality of their forestland with their family, forester, or visitors.

In this winter edition of the Forest Stewardship Community newsletter, we'll be highlighting UC ANR resources for mapping, including the new Forest Stewardship Series #26: Mapping Forest Features.

Warmly,
Grace Dean
Forest Stewardship Communications Specialist
gndean@ucanr.edu

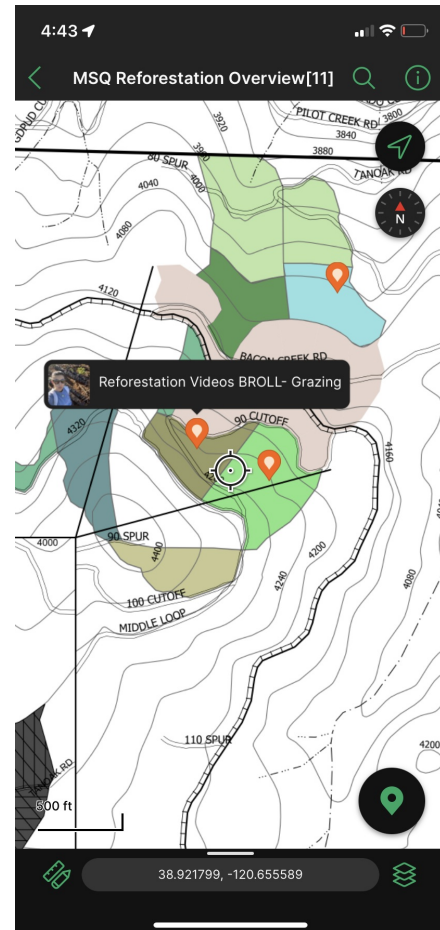

Learning how to use Avenza came in handy when I was exploring reforestation plots at UC Berkeley's Blodgett Forest Research Station. The placemarks are a very helpful feature!

Exploring Forest Stewardship Series 26 **with Rick Satomi**

Rick is a UC ANR Forest Advisor for Sutter-Yuba, Butte, and Nevada Counties.

UC ANR's Forest Stewardship Series has a new addition! Forest Stewardship Series 26: Mapping Forest Features is a peer-reviewed deep dive into the world of forest mapping, from planning to creation. Highlights of Series 26 include a guide to

commonly required maps when developing a California Cooperative Forest Management Plan (p. 2); advice for selecting your mapping tool of choice (p. 3) and guidance for data type representation of forest features on maps (p.7).

Even if you are not a forest landowner, creating maps is fun practice while doing outdoor activities like hiking or camping. Consider recording favorite trees or trails, then noting changes over time.

Keep reading to see our Q&A with Stewardship Series 26 co-author and UC ANR Forest Advisor Rick Satomi!

"All maps are imperfect representations of reality. Rather than capturing every physical detail, maps should highlight key information to help readers interpret the features in a landscape."

-Forest Stewardship Series 26

**READ THE FULL
STEWARDSHIP SERIES 26**



Forest Stewardship participants practice their mapping skills at a field day.

Don't Get Lost: Q&A with Rick

"A map needs to have a purpose. A map needs to tell a story, and that story is usually about what has happened in one place."

Q: It may feel overwhelming to map a large property with various landscape features. What are some recommendations you have for making the process more manageable?

A: "The first thing to remember is that you as a landowner know a lot more about your property than you realize. You have the lived experience- the history, random species that you saw once while on a walk- qualitative information that you as a landowner can begin noting on a map. You can also start with the well established features. Things that are easy to find: roads, water courses, and power lines. Start with what you know."

Q: How does a property map help you provide advice to landowners?

A: "Maps can help create a shared understanding between me and a landowner. When a landowner comes to me with their property map, I can see known features and identify potential gaps in information. It's a good starting point to cross

reference with other resources. Maps serve multiple functions other than showing property features: it's a way for me and a landowner to sit together, and make sure that we are seeing the same things so that our intentions are aligned."

Q: Say someone is already familiar with the basic functions of Avenza (placemarks, GPS tracks, etc.) What are some tools or techniques to explore next?

A: "Now that you have the basics, you can explore and collect other types of data. One suggestion is to start filling in the more detailed information that is covered in the Forest Stewardship workshops: doing inventory, identifying stream classes, completing wildlife surveys. Some landowners are very ambitious and will start tracking the management activities they complete. Doing something like this can give you a sense of how much time and resources it would take to treat a larger area of your property."

STATEWIDE UC ANR FORESTRY NEWS

Stay up to date with the latest events and stories across California!



JOB OPENING

Join our Post-Fire team!

The UC ANR Post-Fire team is seeking an Instructional Designer 2! The Instructional Designer will aid the development, testing, and launching of an asynchronous online post-fire management education program.

Interested applicants can learn more about the position and apply below. **The first application review date will be January 13, 2025.**

UC ANR is an equal opportunity provider and employer.

**VISIT JOB
PAGE**

ENVIRONMENTAL EDUCATION

Applications are open for the Forestry Institute for Teachers.

Are you or is someone you know a K-12 teacher interested in learning more about forestry? If so, apply to FIT today! The Forestry Institute for Teachers (FIT) is a unique program for California teachers to explore environmental education techniques and curriculum in a forested setting.

Participants spend a week in the woods learning from forestry experts and building community with peers from across the state.



FIT is offering sessions in El Dorado, Tuolumne, Shasta, and Humboldt Counties in June and July 2025. Learn more at the FIT website [HERE](#).

Apply to FIT before December 31st and qualify for the early bird discount!

Registration is \$80 until 12/31. Registration is \$125 from January 1 onward.

**APPLY TO
FIT**

UCCE WELCOMES NEW BIOMASS ADVISOR

Say hello to Ali Azadfar!

Biomass and Forest Products Advisor Ali Azadfar joined UCCE's Siskiyou County office this fall, bringing years of expertise to the region. Ali's work in forest products innovation has taken him across the globe: from Iran to Washington state to upstate New York: **"Despite geographic and cultural differences, I've observed a universal desire to protect forest ecosystems and maintain their sustainability."**



**READ THE FULL
STORY**

OAK WOODLAND RESTORATION

UCCE's Yana Valachovic explains new permit options for oak woodland managers.

Great news for landowners managing conifer encroachment on their oak woodlands: new permit

options in California have been introduced, including a new special prescription that does not require conifer replantings post-harvest. A blog by Del Norte/Humboldt Forestry and Natural Resources Advisor Yana Valachovic breaks down two new regulatory pathways for landowners: **"For decades, barriers in the California Forest Practice Rules have made managing these woodlands experiencing encroachment difficult.**

Fortunately, there is good news. New permit options are available for private forest landowners who want to remove these encroaching trees and sell some of the by-products of restoration activities."



[READ THE FULL STORY](#)

UPCOMING EVENTS

Forest Stewardship Workshop- Sonoma County

When: Online January 21-March 18, 2025; in-person field trip Saturday February 22, 2025

Where: Zoom and in-person

[REGISTER](#)

Post-Fire Forest Resilience Workshop-Butte and Tehama

When: Online February 6-March 20, 2025; in-person field trip Saturday March 22, 2025

Where: Zoom and in-person

[REGISTER](#)

2025 California Tree School- Santa Cruz

When: Saturday April 5, 2025

Where: San Lorenzo Valley High School, Felton CA

[REGISTER](#)

2025 California Tree School- Oakhurst

When: Saturday April 12, 2025

Where: San Lorenzo Valley High School, Santa Cruz County

[REGISTER](#)

OLD GROWTH

Rediscover forest stewardship classics!

Welcome to a new section of the newsletter: Old Growth! Each newsletter, I'll share

a memorable blog, paper, or video from the past years. For this edition, I'd like to highlight our CFIP blog, which was published in 2020. The blog provides a great overview of the financial assistance program CFIP (California Forest Improvement Program) offered through CALFIRE, and includes an awesome Q&A with CALFIRE Forestry Assistance Specialist Zsolt Katay.

Whether you're thinking about applying for CFIP funding in 2025 or are looking to explore options to present to landowner clientele, this blog is a great place to start learning more.

READ THE
BLOG

Would you like to see a specific topic addressed in the next Old Growth section? Send me an email anytime at gndean@ucanr.edu.

Keep in touch!



University of California Cooperative Extension | 137 Mulford Hall, #3114 | Berkeley, CA 94720-3114 US

[Unsubscribe](#) | [Update Profile](#) | [Constant Contact Data Notice](#)



Try email marketing for free today!